

General instructions

1. PRINT ALL PAGES AT 100% SCALE.
2. Cut out templates and assemble as per page instructions.
3. Insert the assembled tube body from the back of the wheel until it is flush against the center cap flange.
4. Slide the disc template down the tube, check for spoke clearance and lug nut clearance. Record the height as indicated where template meets the tube measurements.
5. Reference the chart on page 5 for the corresponding kit for your application.

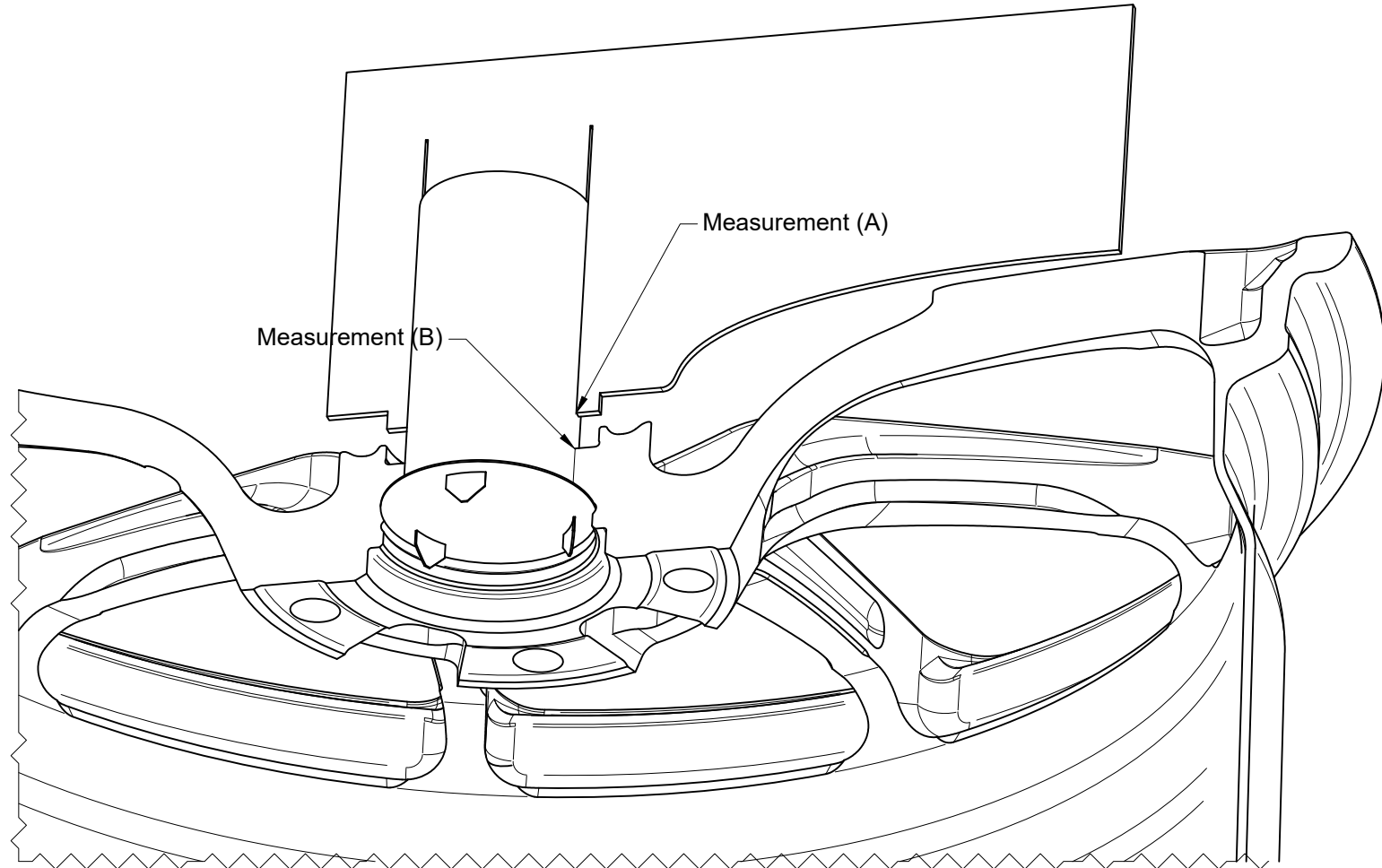

**VERIFY THAT THE MEASUREMENTS ON THE TEMPLATE WITH A RULER.
ALL PAGES MUST BE PRINTED TO SCALE/ACTUAL SIZE. Do not print "Fit to page"**

9.5in [241mm]



380x25 Aero Disc Template

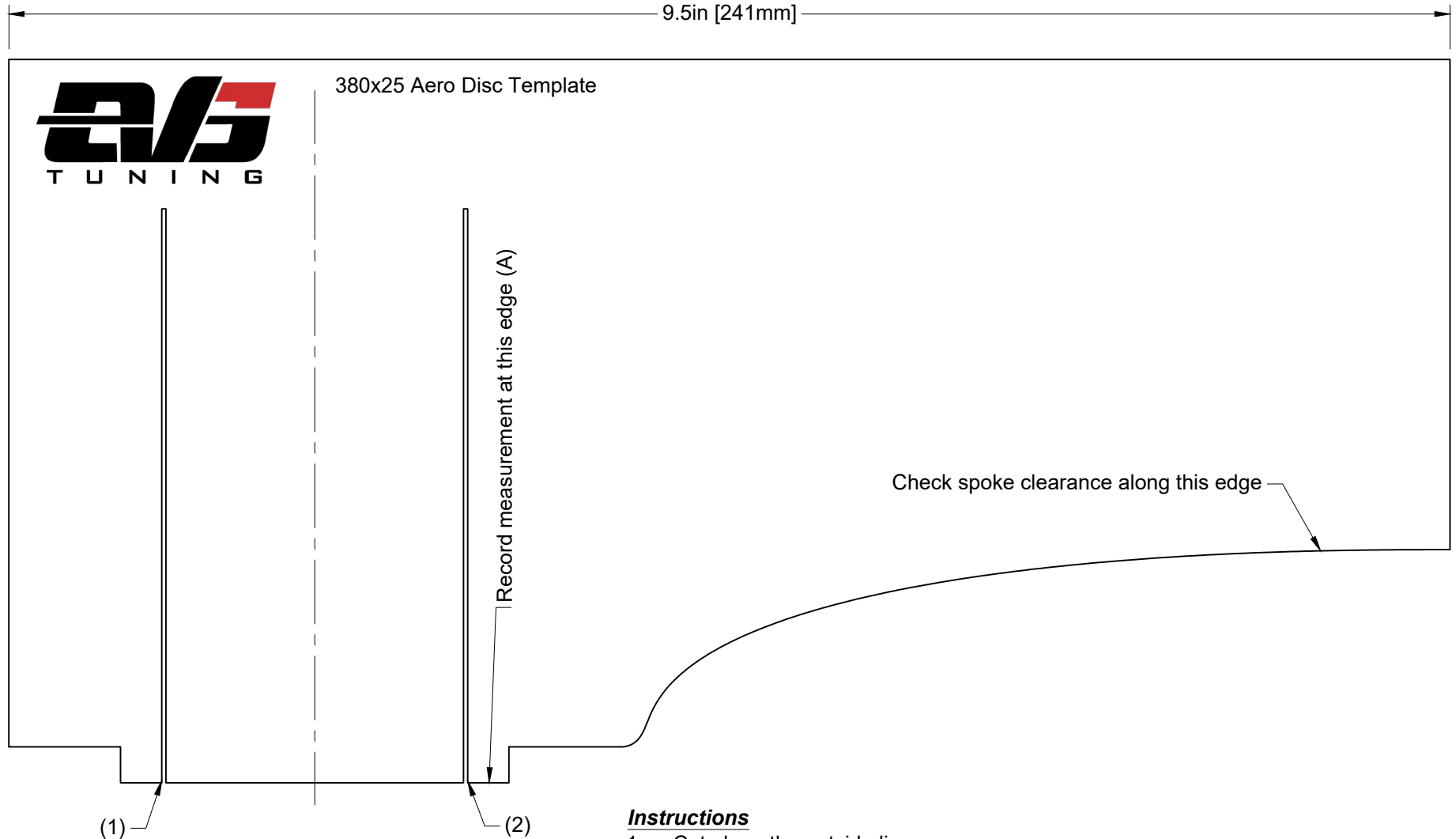

Instructions

1. Cut along the outside lines.
2. Make a narrow slit along lines (1) and (2)

This template part is recommended to be printed on heavy weight paper or glued to a file folder for rigidity. Do not use cardboard.



PROJECT	Aero Disc Template	SCALE	1:1	SIZE	A
PART NO	Wheel Clearance Template	DRAWN	03/13/2026	REV	SHEET 2/5

**VERIFY THAT THE MEASUREMENTS ON THE TUBE BODY TEMPLATE WITH A RULER.
ALL PAGES MUST BE PRINTED TO SCALE/ACTUAL SIZE. Do not print "Fit to page"**

Instructions

1. Cut out along the exterior lines.
2. Roll into a tube along the dotted edge and secure with tape/glue.

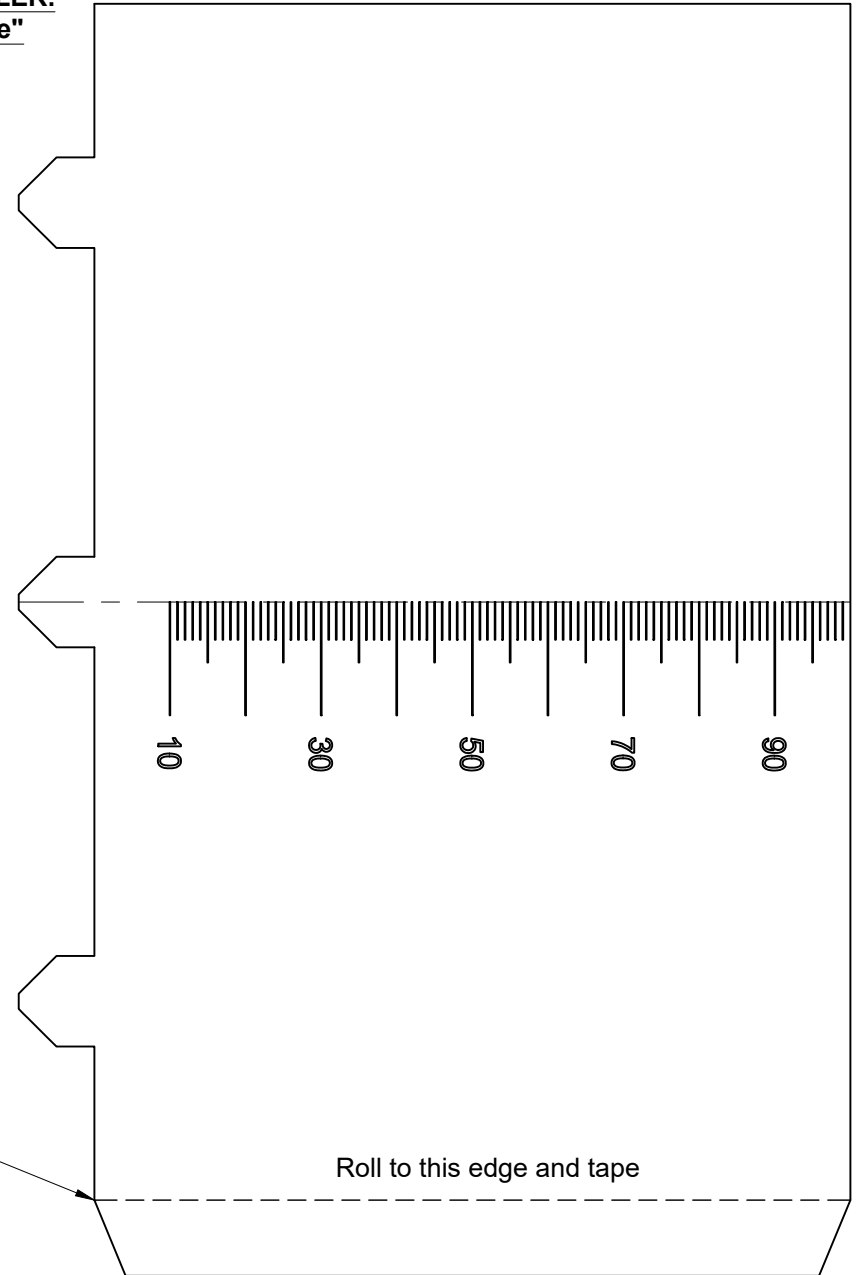
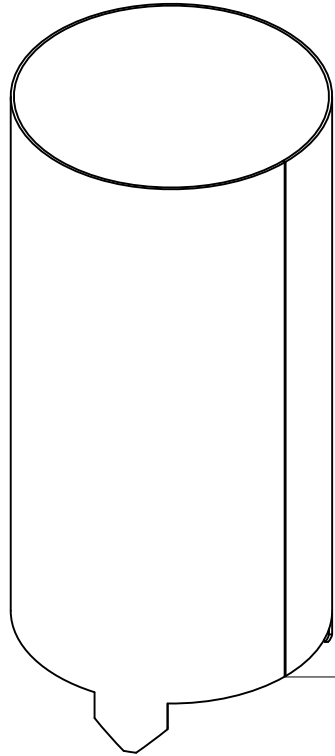

Cut along outer for center cap openings greater than 58mm

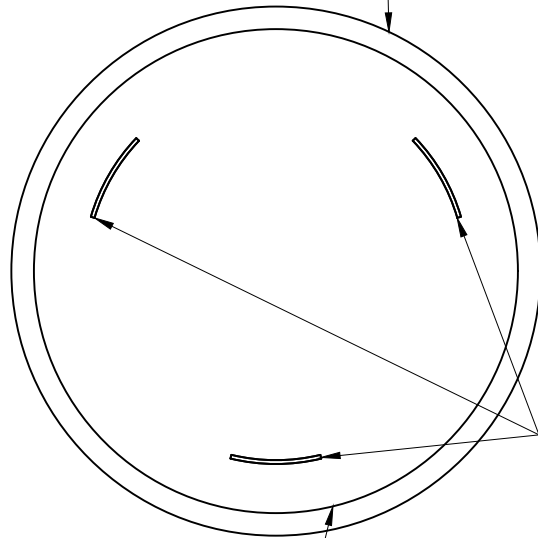

Slit for tube body.

Cut along this line for center cap openings between 50 and 58mm

Tube Body

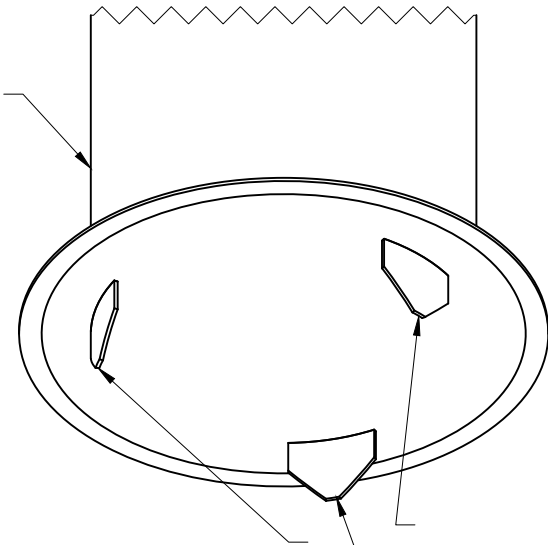

Fold and tape.

Instructions

1. Cut out the base as indicated. It is recommended to use a heavy weight paper or file folder as backing.
2. Assemble the tube body from page 3 and flange body together by sliding the tabs into the slots and folding flat with tape.

AERO DISC KIT

PART NUMBER	MEASUREMENT (A)	MEASUREMENT (A) - (B)*
EVS-AD-38035-050-0152	<38MM	10 ~ 25MM
EVS-AD-38035-075-0353	38MM ~ 60MM	30 ~ 45MM

* If MEASUREMENT (A)-(B) is larger than indicated in the chart, you may need additional spacers listed below,

Extra Components

PART NUMBER	DESCRIPTION
EVS-AD-AR01	For cap diameter >58mm and/or center cap lip thinner than 3mm.
EVS-AD-AR02	For cap diameter >58mm with recessed pocket(See Fig 1)
EVS-AD-S005	Additional 5mm spacer kit.
EVS-AD-S010	Additional 10mm spacer kit.
EVS-AD-S020	Additional 20mm spacer kit.

Fig. 1

For some wheels, the center cap inside diameter is larger than 58mm and the hub bore diameter is equal to or smaller than the center cap diameter.

Examples: Rays "M-Spec", OEM Honda Type R.

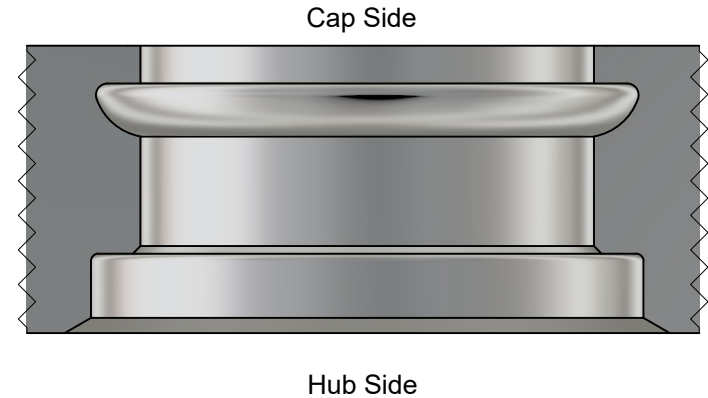
**Special Notes**

- Please be aware of the axle nut diameter and height when installed on the drive side wheel. The stud has 12mm of clearance from the back of the cap mounting face.
- Wheels without a center cap lip, such as ADVAN wheels and RAYS SL/Super Lap style wheels cannot be mounted. A special adapter will be available at a later date.
- For 17" and smaller wheels, valve stem access may be an issue.